

TBE-FIX-PL-001: Plastic DIN-Rail clip installation on termination board enclosure

For **TBE-D50xx-TRI-xxx** or **TBE-D50xx-GMI-xxx** termination board with 1x or 2 x Plastic DIN-Rail clips TBE-FIX-PL-001, extract each clip and related instruction sheet from plastic bag. Follow the instruction sheet and the following figures to change lever position (from default to specific for TBE-D50xx-TRI-xxx or TBE-D50xx-GMI-xxx) on each clip:

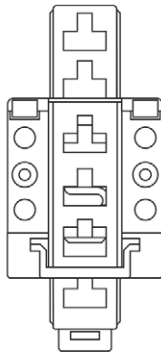

Default position

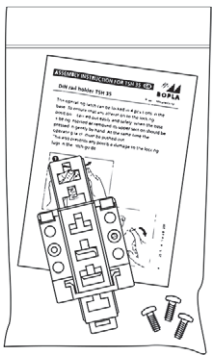
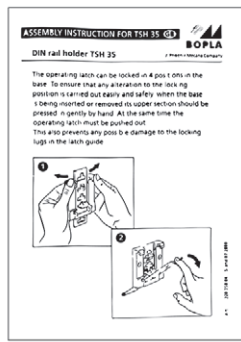

Instruction sheet

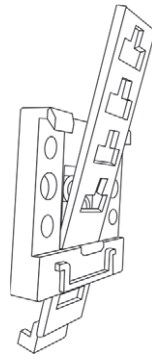

Changing lever position

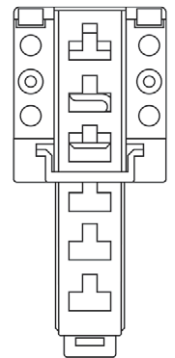
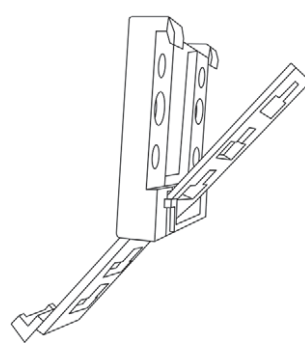

Specific position for
TBE-D50xx-TRI-xxx
TBE-D50xx-GMI-xxx

For the termination boards **TB-D5016-TRI-010** and **TBE-D5016-TRI-010**, place the enclosure as shown in the following figures and fix each Plastic DIN-Rail clip to enclosure by 2 x M3 (10 mm) screws included on plastic bag of TBE-FIX-PL-001 set:

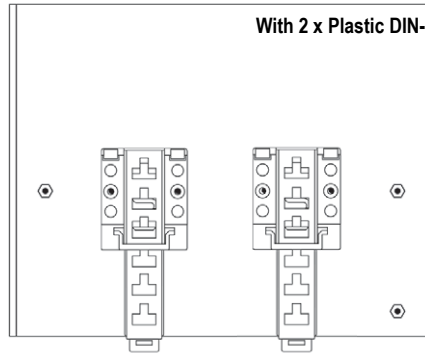
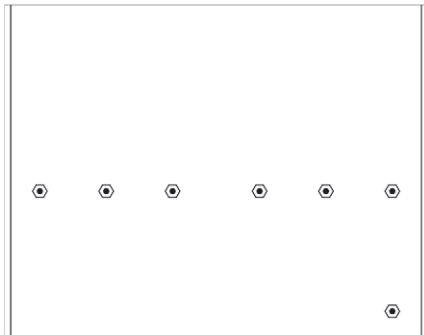

With 2 x Plastic DIN-Rail clips TBE-FIX-PL-001

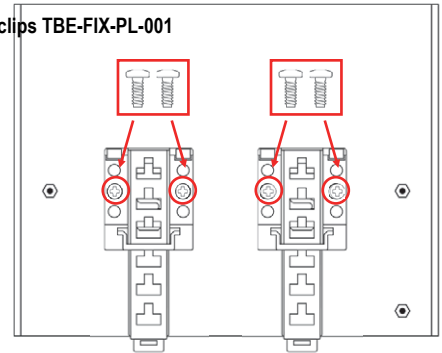

For the termination boards **TBE-D5016-TRI-xxx (with xxx different from 010)** and **TBE-D5016-GMI-xxx**, place the enclosure as shown in the following figures and fix each Plastic DIN-Rail clip to enclosure by 2 x M3 (10 mm) screws included on plastic bag of TBE-FIX-PL-001 set:

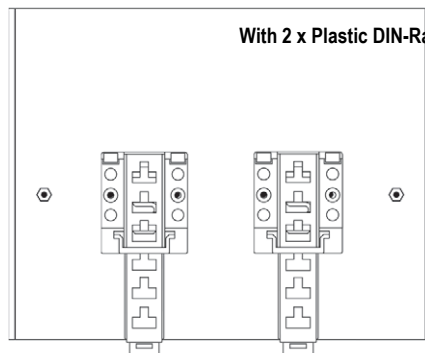
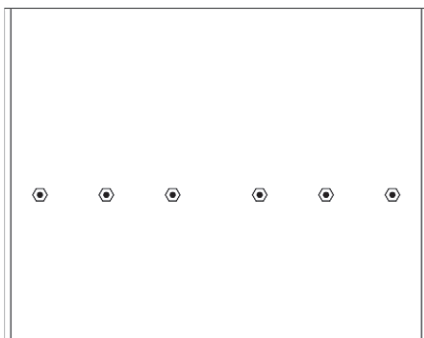

With 2 x Plastic DIN-Rail clips TBE-FIX-PL-001

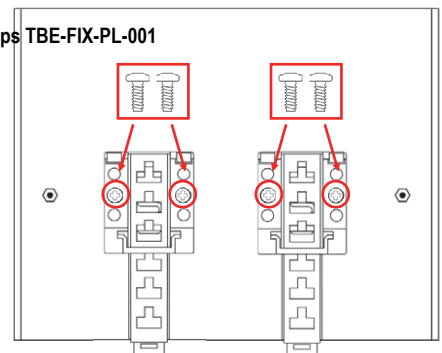

For the termination board **TBE-D5008-TRI-xxx** and **TBE-D5008-GMI-xxx**, place the enclosure as shown in the following figures and fix Plastic DIN-Rail clip to enclosure by 2 x M3 (10 mm) screws included on plastic bag of TBE-FIX-PL-001 set:

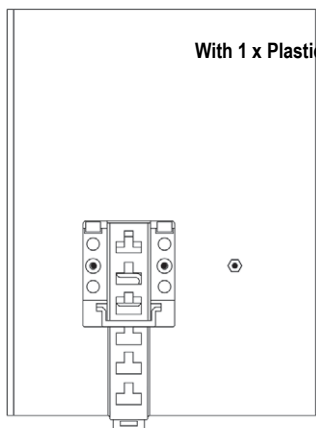
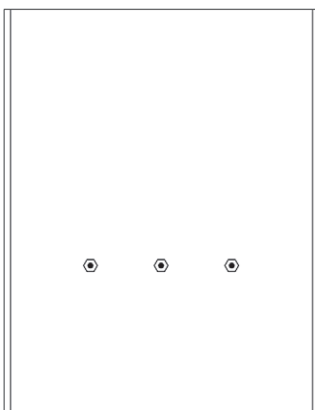

With 1 x Plastic DIN-Rail clip TBE-FIX-PL-001

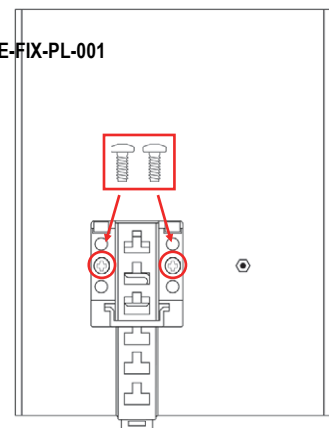

TBE-FIX-PL-001: Plastic DIN-Rail clip installation on termination board enclosure

For **TBE-D5001-HRT-xxx** or **TBE-D5001-TRI-xxx** termination board with 2 x Plastic DIN-Rail clips TBE-FIX-PL-001, extract each clip and related instruction sheet from plastic bag. Follow the instruction sheet and the following figures to change lever position (from default to specific for TBE-D5001-HRT-xxx or TBE-D5001-TRI-xxx) one each clip:

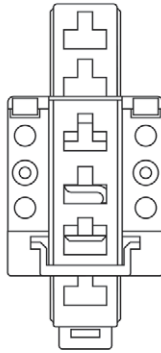
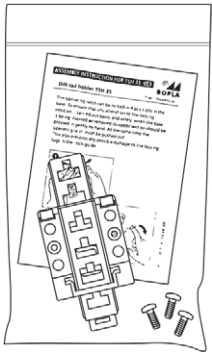

Default position

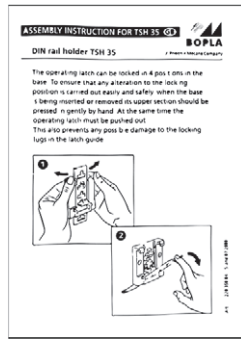

Instruction sheet

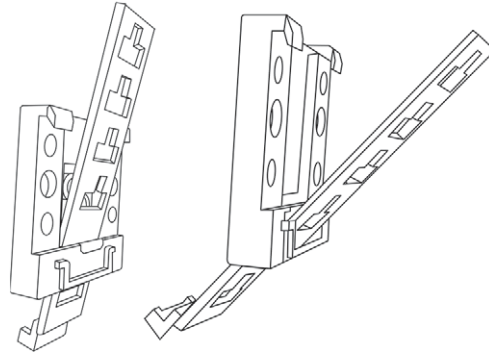

Changing lever position

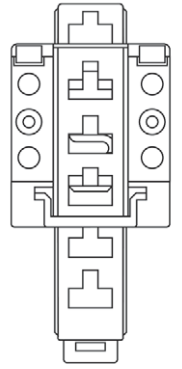

Specific position for
TBE-D5001-HRT-xxx
TBE-D5001-TRI-xxx

For the termination boards **TBE-D5001-HRT-xxx** and **TBE-D5001-TRI-xxx**, place the enclosure as shown in the following figures and fix each Plastic DIN-Rail clip to enclosure by 2 x M3 (10 mm) screws included on plastic bag of TBE-FIX-PL-001 set:

